

U-Control II™ User Manual

Integrated

Communication

Systems

And Computer

Access Software

Designed

For the Way

You Live



U-Control II

Table of Contents

| | |
|---|-----------|
| Introduction | 1 |
| The Keyboard | 2 |
| Getting Started | 2 |
| If Your Device Does Not Respond | 3 |
| Determining the 3-Digit Code | 4 |
| Additional Features | 4 |
| Punch-Through | 5 |
| On and Off the Punch-Through | 5 |
| Upgrading Code Information | 5 |
| Helpful Hints | 6 |
| Manufacturer Set Up Codes | 7 |
| Audio Amplifiers | 7 |
| Audio Amp/Tuners | 7 |
| Audio Cassette..... | 8 |
| Miscellaneous Audio | 8 |
| Cable Box..... | 9 |
| CD Player | 10 |
| Home Automation..... | 11 |
| Laser Discs | 12 |
| Satellite Receivers | 12 |
| Television | 13 |
| Video Accessories | 15 |
| VCRs | 15 |
| U-Control Command Center Setup | 17 |
| Turning On and Off Lights and Appliances | 18 |
| Intercom Systems | 19 |
| Power Interruptions | 19 |
| Manual Control | 19 |
| Safety Precautions | 19 |
| Turning On and Off All Lights and Appliances | 19 |
| Troubleshooting | 20 |
| FCC Compliance | 21 |
| Instruction to the User | 22 |

Introduction

Congratulations on your purchase of the U-Control II. The U-Control II lets you operate almost any infrared device in your home. It can replace up to six standard remote controls. The U-Control II is preprogrammed with codes for devices made by most manufacturers. The UCII is designed to be operable from a computer or AAC device running Words+, Inc. software. Four AAA batteries are required to power your U-Control II.

This manual is divided into three sections.

Section 1 provides an introduction to the U-Control II and describes basic requirements for using it. You will find out how to set up and upgrade codes for the products of different manufacturers.

Section 2 provides 3-digit manufacturer codes for TVs, VCRs, cable converters, laser disc players, satellites, and home automation units.

Section 3 describes the Command Center. This section explains the function of the Command Center, how you install it, and how your Remote Control and Command Center work together. This section also features tips on the safe operation of the Command Center.

The Keyboard

LED - A red LED flashes during operation of the Universal Remote Control.

SET UP - This key is used in setting up your devices.

Device Keys - The device keys (**CD, VCR, CBL, TV, AUX1, AUX2,** and **PLUG 'N POWER**) select the home entertainment device to be controlled. For example, pressing the TV key allows the remote to control all of the functions of your TV.

POWER, MUTE, LAST, and **ENTER**- These keys operate in the same way as the corresponding keys on your original remote control.

Audio and Video Sequences - Not available in this program.

Surround Sound and **Shift Keys** - These keys are for controlling your surround sound system and other similar devices, but they are not available in this program.



LIGHT- To use your keypad in dark or dimly lit rooms. Toggles the backlight between the “on” and “off” positions. In the “on” position, the keypad lights up every time a key is pressed and stays lit for about five seconds.

SCAN- Allows you to browse through channels on your TV, VCR, and cable box.

PROG, TV/VCR, and **DISPLAY** - These keys operate in the same way as the corresponding keys on your original remote control.

Getting Started

The U-Control II comes preprogrammed with codes for several devices made by different manufacturers. You must begin by setting up the operation and control of your specific set of devices.

1. Look up the device you want to control (TV, VCR, cable box, etc.) in the section of this manual that lists set-up codes. Codes are listed by manufacturer, with the most frequently used codes appearing first.
2. Press the device key (**CD, VCR, CBL, AUX1, AUX2**) on your Remote Control.
3. Press and hold the **SET UP** key until the red indicator light blinks twice, then release it. Enter the three-digit code.

For example, to set up your **TV**, enter the three-digit code as follows:

TV-SET UP-1-2-3

4. When the red indicator light blinks twice again, the Remote Control has accepted the code. Aim the Remote Control at your TV and press **POWER** to complete the operation.
5. Repeat these easy steps for other devices, making sure to substitute the appropriate device key.
For example:

CD-SET UP-000 (Sony CD player)

AUX2-SET UP-102 (NEC satellite)

5. If the three-digit code you chose does not operate your device, check the other codes listed in the set-up code section of this manual for your particular brand of TV, VCR, or cable box.
6. If your device still does not respond, please follow the steps outlined on the next page of this manual.

7. Some of your devices may not have a pre-labeled key but are located under another key. Here are the locations of some of these devices:

| Located Under | Other Devices |
|-----------------------------------|---|
| TV | TVs only |
| CBL | Cable converters, satellite receivers, and video accessories |
| VCR | VCRs, TV/VCR combinations, laser disc players, cassette decks, and digital audio tape decks |
| CD | CD players, amplifiers, tuners, receivers, and miscellaneous audio products |
| AUX1 key | VCRs, audio cassette and laser disc players, cassette decks, and digital audio tape decks |
| AUX2 key | Cable converters, satellite receivers, and video accessories |
| PLUG 'N POWER (PnP key) | X10 home automation devices |

If Your Device Does Not Respond

If your device does not respond, you may not have the correct control code programmed. When this occurs, try all of the code numbers for your manufacturer's device. If it still doesn't work, the correct control code is probably in your Remote Control but is listed under a different manufacturer (sometimes manufacturers put their brand name on products made by other manufacturers). If this occurs, search the library of devices provided in the U-Control II to locate the proper code. To start the search process for your TV, for example, follow these simple steps:

1. Turn on the TV.
2. Aim the U-Control II Remote Control at your TV.
3. Press and hold **SET UP** until the red indicator light blinks twice. Release **SET UP** and press **9-9-1**. The red indicator light blinks twice again.
4. Slowly alternate between the **POWER** key and the device key. ***

SET UP-9-9-1-PWR-TV-PWR-TV-PWR.....

Each time you press the TV key, the Remote Control advances to the next manufacturer's code in the library.

5. When your device responds, immediately press **SET UP** to lock in the manufacturer's code.

***You may have to repeat the process for several minutes, so be patient. It only takes a moment.

If you are still having a problem finding a code that works, refer to the "Upgrading Code Information" section on page 5.

Determining the 3-Digit Code

After you set up your U-Control II using the manual code search, you can find the 3-digit code your U-Control II is set to by following these steps:

1. Press the device key for which you want the manufacturer's code.
2. Press and hold **SET UP** until the red indicator light blinks twice, then release it.
3. Press **9-9-0**. The red indicator light blinks twice again.
4. Press **1** and count the number of times the red indicator light blinks. This is the first number of your 3-digit manufacturer's code.

Note: If the red indicator light does not blink, the digit is zero.

5. Press **2** and count the number of times the red indicator light blinks. This is the second number of your 3-digit manufacturer's code.

Note: If the red indicator light does not blink, the digit is zero.

6. Press **3** and count the number of times the red indicator light blinks. This is the third number of your 3-digit manufacturer's code.

Note: If the red indicator light does not blink, the digit is zero.

Additional Features

How to Add a Second Device

If you wish, you can assign a second TV (or VCR, cable box, etc.) to any unused device key on the U-Control II. Here are the steps you should follow:

1. Press **SET UP** until the red indicator light blinks twice.
2. Press **9-9-2** and wait for the red indicator light to blink twice. Press the key for the second device. The red indicator light blinks twice again.

For example, to convert an unused **AUX1** key into a second **VCR** key:

SET UP-9-9-2-VCR-AUX1

3. To change the **AUX1** key back to its original function, press the following buttons in sequence:

SET UP-9-9-2-AUX1-AUX1

Punch-Through

Punch-through allows you to operate several devices simultaneously without having to repeatedly change device keys.

Most other universal remotes require switching between devices to control frequently used features. The U-Control II eliminates this annoyance. While watching cable, you have access to the TV volume, the most frequently used feature. While playing a movie on the VCR, TV volume is again right at your fingertips.

If the last key you pressed was

You can control

CABLE

TV volume, mute, VCR play, pause, fast forward, rewind, record, TV/VCR

TV

VCR play, pause, fast forward, rewind, record, TV/VCR

VCR

TV volume, mute

On and Off the Punch-Through

1. Press the device key (TV or VCR) for the device you want to use to control the volume, then press **SET UP** until the red indicator light blinks twice.
2. Press **9-9-3**. The red indicator light blinks twice again. Press the device key (TV or VCR) for the device you want to use to control the volume. The red indicator light blinks twice to indicate that punch-through is turned off.
3. To turn on the punch-through feature, press **SET UP-9-9-3-TV**. The red indicator light blinks twice to indicate that punch-through is turned on.

Upgrading Code Information

Because the U-Control II is upgraded by telephone, it can be used for most devices you purchase in the future. For example, if you buy a new TV in six months or two years, simply follow these instructions:

1. Call the dealer's customer service hotline at 1-800-950-7044. Your model # is 15-1918
2. Tell the customer service representative the brand name, model number, and the manufacturer's date for each infrared device you want to load into your U-Control II.
3. After presenting your information to the customer service representative, press **SET UP** until the red indicator light blinks twice, then press **POWER**. The red indicator light stays lit throughout the download process.
4. Hold the U-Control II Remote Control up to the telephone earpiece as shown here.

Note:

- You must hold the earpiece of your telephone over the receiver of the U-Control II Remote Control as shown here. If you do not, the U-Control II might not properly receive the information coming over the telephone.



- While the U-Control II is receiving information, the red indicator light blinks occasionally to confirm the information transfer.
- When the U-Control II has successfully received the information for your infrared devices and downloading is complete, the red indicator light blinks twice.

Helpful Hints

The lights on the keyboard don't come on when you press the light button.



Replace the batteries with four fresh AAA alkaline batteries. Charged batteries are required for proper operation.

The U-Control II doesn't operate your device.

1. Try all the codes listed under the manufacturer of your device in the set-up code section of this manual.
2. Try searching the U-Control II's library for the appropriate device code by repeating steps 1-5 on page 3 of this manual. Make sure that when you press **POWER** or **PLAY**, you are aiming the U-Control II at your device.

Since the library is large, please be patient as you scan through each of the devices. If your device turns off during the search but does not operate after you lock in your code, begin the search again, pausing longer between key presses.

Your TV (or other device) responds to some of the commands, but the wrong thing happens.

Unfortunately, many devices use very similar remote control codes. While searching the library you may have locked on to a similar code for which some commands work, but others don't. To locate the proper code, simply start the library search cycle over again, progressing through the library until you discover the code that is an exact match.

For technical support regarding U-Control II with EZ Keys or Talking Screen call **1-800-869-8521**

For obtaining codes for specific devices call 1-800-950-7044 and refer to the "Upgrading Code Information" on page 5 of the manual

Manufacturer Set Up Codes

AUDIO AMPLIFIERS

| Manufacturer | Code(s) |
|---------------------|--------------------|
| Aiwa | 406 |
| Denon Unified | 160 |
| GE | 078 |
| Goldstar | 031 |
| Harman Kardon | 106 |
| Kenwood | 297, 356 |
| Luxman | 165 |
| Marantz | 321 |
| NEC | 092, 116, 131, 264 |
| Optimus | 395, 013, 300 |
| Philips | 269 |
| Pioneer | 300, 257 |
| Pioneer Unified | 013 |
| Realistic | 395 |
| Sansui | 321 |
| Shure | 264 |
| Sony | 220 |
| Soundesign | 078, 211 |
| Technics | 308, 372, 374 |
| Yamaha | 143, 354 |

AUDIO AMP/TUNERS

| | |
|-----------------|------------------------------|
| Adcom | 002, 304, 319 |
| Aiwa | 121, 158, 064, 301, 405, 361 |
| Akai | 076, 450 |
| Carver | 008, 042, 270, 189, 360 |
| Casio | 195 |
| Denon Unified | 004 |
| Fisher | 042, 360 |
| GE | 260 |
| Garrard | 146, 286, 407 |
| Goldstar | 057 |
| Harman Kardon | 110, 107 |
| Inkel | 066, 062 |
| JVC | 074 |
| Kenwood Unified | 313, 027, 314, 186 |
| LXI | 181 |
| Luxman | 166, 329 |
| Magnavox | 189, 195, 128 |
| Marantz | 006, 189, 128, 039 |
| MCS | 044, 039 |
| Memorex | 335 |
| NAD | 320 |
| Nakamichi | 075, 347 |
| Nikko | 215, 322, 407 |
| Onkyo | 100, 119, 135, 144, 380 |
| Optimus | 186, 177, 080 |
| Panasonic | 039, 389 |
| Penney | 195, 449 |
| Philips | 189 |

| | |
|-----------------|-----------------------------------|
| Pioneer Unified | 014, 080, 150 |
| Proton | 026, 047 |
| Quasar | 039 |
| RCR Unified | 054, 360 |
| Realistic | 181, 182, 163, 178, 001, 025 |
| STS | 217, 189, 193, 323 |
| Scott | 105, 163, 322, 418, 396, 390, 449 |
| Sharp | 117, 186 |
| Sherwood | 062, 066, 324 |
| Sony Unified | 158, 168, 415, 474 |
| Symphonic | 182 |
| TEAC | 163, 298, 463, 387 |
| Technics | 039, 208, 309, 518 |
| Techwood | 364 |
| Vector Research | 218 |
| Yamaha | 176, 081, 186 |
| Yorx | 195 |

AUDIO CASSETTE

| | |
|----------------|--------------------|
| ADC | 171 |
| Aiwa | 029 |
| Akai | 188, 189 |
| Carver | 029 |
| Denon Unified | 076 |
| Fisher | 074 |
| Garrard | 300, 439 |
| Harman Kardon | 182 |
| JVC | 244 |
| Kenwood | 070, 071, 092 |
| Kyocera | 171 |
| Luxman Unified | 091, 095 |
| Magnavox | 029 |
| Marantz | 029 |
| NAD | 144 |
| NEC | 165 |
| Nakamichi | 147 |
| Onkyo Unified | 100, 136 |
| Optimus | 300, 439, 027, 220 |
| Panasonic | 250, 272 |
| Philips | 029 |
| Pioneer | 027, 099, 220 |
| Proton | 028 |
| Sansui | 029 |
| Sony | 170, 243 |
| Wards | 027 |
| Yamaha | 094 |

MISCELLANEOUS AUDIO

| | |
|--------------|---------------|
| ADC | 086 |
| Aiwa | 010, 159, 404 |
| Audio Source | 351 |
| BSR | 086 |
| Carver | 351 |

| | |
|--------------------|----------|
| Denon | 359 |
| Fisher | 052 |
| Harman Kardon | 477 |
| JVC | 073 |
| Jerrold | 459 |
| KLH | 351 |
| Luxman | 326 |
| Mitsubishi | 132 |
| NEC | 236 |
| Pioneer | 089, 248 |
| Proton | 046 |
| RCA | 056, 248 |
| Schneider | 376 |
| Scientific Atlanta | 460 |
| Sony Unified | 010, 159 |
| Soundesign | 376 |
| Technics | 517 |
| Yorx | 376 |

CABLE BOX

| | |
|---------------------|---|
| ABC | 011, 014, 007, 013, 017, 003, 001 |
| Antronix | 207 |
| Archer | 022, 207, 039, 153 |
| Cable Star | 056 |
| Century | 153 |
| Citizens | 153, 315 |
| Comtronics Eagle | 060, 040 |
| Contec | 019 |
| Eastern | 002 |
| GC Electronics | 056, 207 |
| GE | 233, 232 |
| Gemini | 057, 070, 015, 242 |
| General Instruments | 011, 003, 476 |
| Hamlin | 020, 034, 259, 009 |
| Hitachi | 011 |
| Jasco | 153, 315 |
| Jerrold | 003, 014, 011, 026, 024, 015, 047, 098, 276, 012, 476 |
| Macon | 033 |
| Magnavox | 027, 032 |
| Memorex | 000 |
| Movie Time | 078, 203, 063 |
| NSC | 063, 070, 203 |
| Oak | 007, 019, 248 |
| Panasonic | 021, 107 |
| Paragon | 000 |
| Philips | 060, 153, 027, 028, 029, 030, 031, 290, 025, 242 |
| Pioneer | 144, 023, 260 |
| Popular Mechanics | 400 |
| Pulsar | 000 |
| RCA | 021 |
| Realistic | 207 |
| Regal | 279, 020, 059, 273 |
| Regency | 002 |
| Rembrandt | 070 |
| SL Marx | 040 |

| | |
|--------------------|--|
| Samsung | 144, 040 |
| Scientific Atlanta | 008, 277, 017, 006, 327 |
| Signal | 040 |
| Signature | 011 |
| SL Marx | 040 |
| Sprucer | 021, 307 |
| Starcom | 015, 047, 003, 098 |
| Stargate | 040, 015 |
| Sylvania | 001 |
| Telecaption | 211 |
| Texscan | 001, 096 |
| Tocom | 013, 059, 012 |
| Toshiba | 000 |
| Unika | 207, 153, 022 |
| United Artists | 007 |
| United Cable | 003 |
| Universal | 078, 056, 077, 207, 022, 039, 191, 153 |
| Viewstar | 027, 060, 063, 111, 211 |
| Zenith | 000, 054 |

CD PLAYER

| | |
|----------------|-------------------------|
| ADC | 018 |
| ADS | 243 |
| Adcom | 192, 155, 234 |
| Aiwa | 012, 124, 249 |
| Akai | 156 |
| Audio Alchemy | 194 |
| Audio-Technica | 170 |
| BSR | 194 |
| California | |
| Audio Lab | 029 |
| Capetronic | 237 |
| Carrera | 194, 394 |
| Carver | 157, 179, 437 |
| Casio | 201 |
| Clarinette | 195 |
| Crown | 122 |
| Curtis Mathes | 201 |
| Denon | 003, 034, 358 |
| Emerson | 155, 305, 164, 469 |
| Fisher | 048, 342, 174, 179, 088 |
| GE | 009, 334, |
| Garrard | 280, 425 |
| Genexxa | 032, 305, 164 |
| Goldstar | 030, 417, 383, 394 |
| Harman Kardon | 109, 108, 173 |
| Hitachi | 032, 155, 386 |
| Inkel | 065, 061 |
| JVC | 072 |
| Kenwood | 028, 037, 048, 190, 340 |
| Kodak | 287 |
| Krell | 157 |
| Kyocera | 018 |
| Luxman | 093, 149, 266, 432, 483 |

| | |
|-----------------|---|
| Luxman Unified | 149, 035, 093 |
| LXI | 305 |
| Magnavox | 157, 225, 129 |
| Marantz | 005, 157, 180, 029 |
| MCS | 043, 029, 201, 454 |
| MGA | 083 |
| McIntosh | 290 |
| Mission | 157 |
| Mitsubishi | 098, 083 |
| Modulaire | 195 |
| NAD | 019 |
| NEC | 043, 234 |
| Nakamichi | 097, 147 |
| Nikko | 170, 174, 164 |
| Onkyo | 102, 101, 138 |
| Optimus | 037, 032, 175, 179, 194, 196, 420, 437, 426, 342, 305 |
| Panasonic | 029, 388 |
| Penney | 043 |
| Philips | 157, 274 |
| Pioneer | 096, 244, 032, 468 |
| Proton | 157, 152 |
| Quasar | 029 |
| RCA | 053, 179, 155, 305 |
| Realistic | 155, 175, 179, 180, 420 |
| Rotel | 157, 420 |
| SAE | 157 |
| Sansui | 157, 305, 202 |
| Sanyo | 179, 087 |
| Scott | 164, 305, 155 |
| Sears | 201, 261, 037, 180, 265, 305 |
| Sharp | 037, 180 |
| Sherwood | 180, 065, 114, 061, 196 |
| Signature | 108 |
| Sony | 000, 185, 490 |
| Soundesign | 145 |
| STS | 018 |
| Sylvania | 157, 225 |
| Symphonic | 183 |
| Tandy | 032 |
| TEAC | 016, 045, 153, 174, 420, 393, 180, 183 |
| Technics | 029 |
| Techwood | 363 |
| Toshiba | 019 |
| Vector Research | 394, 417, 194, 109 |
| Victor | 072 |
| Wards | 108 |
| Yamaha | 036, 170, 187 |
| Yorx | 461 |

HOME AUTOMATION

| | |
|-----------------|-----|
| GE | 240 |
| One-For-All | 167 |
| RadioShack | |
| Security System | 240 |

| | |
|-----------------|-----|
| Universal | 167 |
| One-For-All | |
| Security System | 167 |

LASER DISCS

| | |
|-----------------|----------|
| Aiwa | 203 |
| Carver | 203 |
| Denon | 172 |
| Disco Vision | 023 |
| Funai | 203 |
| Hitachi | 023 |
| Kenwood | 258 |
| Magnavox | 241, 064 |
| Marantz | 064 |
| Mitsubishi | 059 |
| NAD | 059 |
| Panasonic | 204 |
| Philips | 064 |
| Pioneer Unified | 023, 059 |
| RCA | 128, 351 |
| Realistic | 203 |
| Sharp | 001 |
| Sony | 193, 201 |
| Yamaha | 217 |

SATELLITE RECEIVERS

| | |
|---------------------|-----------------------------------|
| Amplica | 072 |
| BSR | 095 |
| Birdview | 045, 079 |
| Capetronics | 095 |
| Channel Master | 018, 212, 257 |
| Chaparral | 053, 209 |
| DX Antenna | 065, 041 |
| Drake | 018, 062, 064, 066, 149, 150, 245 |
| Echostar | 148, 159, 269 |
| Fujitsu | 186, 236 |
| General Instruments | 071, 038, 050 |
| HYTEK | 095 |
| Janeil | 152 |
| Jerrold | 036 |
| Kenwood | 264 |
| Luxor | 083 |
| Macom | 050, 018, 061 |
| Memorex | 269 |
| NEC | 102 |
| Norsat | 004, 165 |
| Panasonic | 152 |
| PRIMESTAR | 361 |
| RCA DSS | 566 |
| Realistic | 051, 052 |
| STS | 041, 065, 190, 210 |
| Scientific Atlanta | 234 |
| Sony DSS | 639 |
| Star Trak | 180 |

| | |
|-----------------|----------|
| Super Guide | 311 |
| Toshiba | 061, 082 |
| Uniden | 076, 052 |
| Video Cypher II | 050 |

TELEVISION

| | |
|---------------|--|
| Admiral | 093, 016 |
| Aiko | 092 |
| Akai | 030, 098 |
| Anam | 180, 068, 004 |
| Anam National | 161, 055 |
| AOC | 019, 030, 185, 137, 052, 003 |
| Audiovox | 003, 180 |
| Bell & Howell | 016, 154 |
| Candle | 046, 186, 030, 056 |
| Capehart | 052 |
| Carver | 054 |
| Citizen | 030, 046, 060, 056, 092, 039, 280, 186 |
| Concerto | 056 |
| Contec | 158, 157, 185, 180 |
| Craig | 180, 161 |
| Crown | 039, 180 |
| Curtis Mathes | 060, 030, 039, 054 |
| Daewoo | 092, 019, 039, 067, 066, 091 |
| Daytron | 039 |
| Dynatech | 049 |
| Electrohome | 039 |
| Emerson | 236, 158, 180, 177, 185, 039, 183, 178, 182, 179, 181, 282, 280, 270 |
| Envision | 030 |
| Fisher | 154, 159 |
| Funai | 179, 180, 171 |
| Futuretech | 180 |
| GE | 047, 051, 055, 021, 027, 178, 174, 279, 251, 282 |
| Goldstar | 060, 056, 178, 030, 019, 002, 001, 106 |
| Hallmark | 178 |
| Harman Kardon | 078 |
| Hitachi | 151, 145, 227, 056, 038, 095, 097, 173, 279 |
| Infinity | 054 |
| JVC | 053, 182, 069, 169 |
| Jensen | 050 |
| KTV | 185, 039, 180, 217, 280 |
| Kamp | 216 |
| Kawasho | 216, 308 |
| Kenwood | 030 |
| Kloss | 078, 046, 024 |
| LXI | 047, 154, 156, 148 |
| Logik | 016 |
| Luxman | 056 |
| MGA | 150, 155, 030, 178, 019 |
| Magnavox | 054, 096, 187, 186, 030, 028, 024, 020, 230 |
| Marantz | 054, 030 |
| Matsui | 217 |
| Memorex | 016, 154 |

| | |
|-----------------|---|
| Mitsubishi | 150, 178, 155, 019, 098, 014 |
| MTC | 019, 060, 056, 049, 030 |
| Multitech | 217, 049 |
| NAD | 156 |
| NEC | 019, 170, 036, 056, 030 |
| Nikko | 030, 092, 317 |
| Onwa | 180 |
| Optimus | 166 |
| Optonica | 093, 165 |
| Panasonic | 051, 055, 054, 338, 162, 250 |
| Penney | 030, 021, 060, 135, 047, 149, 039, 019, 018 |
| Philco | 054, 030, 019, 020, 024, 028, 186, 187, 096 |
| Philips | 054 |
| Pioneer | 166, 038 |
| Portland | 019, 039, 092 |
| Proscan | 047 |
| Proton | 052, 031, 178 |
| Pulsar | 017 |
| Quasar | 055, 051, 219 |
| RadioShack | 154, 032, 165, 039, 180, 030, 178, 019, 056, 047 |
| RCA | 047, 018, 135, 029, 019, 254, 174, 038 |
| Realistic | 154, 032, 039, 165, 180, 019, 030, 178, 056 |
| Sampo | 030, 052, 100, 110 |
| Samsung | 060, 039, 019, 030, 032, 056 |
| Sanyo | 154, 159, 146, 232 |
| Scott | 236, 179, 180 |
| Sears | 148, 047, 154, 158, 178, 146, 159, 056, 179, 149 |
| Sharp | 093, 165, 153, 039, 220 |
| Signature | 016 |
| Sony | 000, 011, 111, 080, 273 |
| Soundesign | 178, 180, 186 |
| SSS | 019, 180 |
| Supre-Macy | 046 |
| Sylvania | 054, 096, 065, 020, 024, 028, 030, 186, 187 |
| Symphonic | 171 |
| Tatung | 055, 049, 003 |
| Technics | 051 |
| Techwood | 056 |
| Teknika | 092, 056, 039, 060, 186, 175, 312, 019, 150, 016, 180, 179, 322 |
| Tera | 031 |
| TMK | 056, 178 |
| Toshiba | 154, 156, 060, 036, 149 |
| Tosonic | 185 |
| Totevision | 039 |
| Universal | 021, 027 |
| Vector Research | 030 |
| Victor | 053 |
| Video Concepts | 098 |
| Vidtech | 178, 019 |
| Wards | 054, 187, 174, 030, 029, 165, 179, 016, 178, 021, 027, 020, 096, 028, 019 |
| Yamaha | 019, 030 |
| Zenith | 017, 016 |
| Zonda | 003 |

VIDEO ACCESSORIES

| | |
|----------------|-----|
| Channel Master | 094 |
| Jebsee | 160 |
| Rabbit | 081 |
| RadioShack | 160 |
| Superguide | 169 |
| Telecaption | 171 |

VCRs

| | |
|---------------|---|
| Action | 317 |
| Aiwa | 000 |
| Akai | 041, 049, 106, 242, 156, 053, 061 |
| Bell & Howell | 104 |
| Broksonic | 211, 184, 121, 361 |
| Canon | 035, 167 |
| Capehart | 020 |
| Carver | 081, 110 |
| Craig | 240, 047, 271 |
| Curtis Mathes | 035, 060 |
| Daewoo | 020, 278, 017, 087, 045 |
| Daytron | 020 |
| Dynatech | 000 |
| Emerson | 184, 278, 068, 211, 121, 061, 209, 208, 212, 000, 088, 037, 036, 294, 002 |
| Fisher | 104, 046, 047, 054, 066 |
| Funai | 000 |
| GE | 060, 202, 035, 065 |
| Garrard | 000 |
| Go Video | 232, 279 |
| Goldstar | 037, 038, 018 |
| Harman Kardon | 038, 075 |
| Hitachi | 000, 041, 042, 105, 166, 065, 235 |
| JVC | 008, 067, 041, 206, 207, 384 |
| Jensen | 041 |
| Kenwood | 067, 008, 041, 046 |
| Lloyd | 000 |
| LXI | 037 |
| Logik | 072 |
| Magnavox | 035, 081, 110, 103, 149, 039 |
| Marantz | 035, 081, 038, 146 |
| Marta | 037 |
| MEI | 035 |
| Memorex | 037, 039, 000, 048, 104, 046, 035, 047, 299, 268 |
| MGA | 043, 242, 061, 075, 214 |
| MTC | 000, 240 |
| Minolta | 042, 105 |
| Mitsubishi | 043, 242, 061, 075, 214 |
| MTC | 000, 240 |
| Multitech | 000, 072 |
| NAD | 058 |
| NEC | 038, 041, 067, 008, 050, 040, 082 |
| Nikko | 037 |
| Optimus | 048 |
| Optonica | 048, 062 |
| Panasonic | 081, 110, 035, 077, 225 |

| | |
|-----------------|---|
| Penney | 240, 038, 035, 040, 042, 037 |
| Pentax | 042, 105, 065 |
| Philco | 035, 081, 110, 062 |
| Philips | 035, 081, 110, 062 |
| Pilot | 037 |
| Portland | 020 |
| Pulsar | 039, 051 |
| Quartz | 046, 155 |
| Quasar | 035, 077, 081, 110 |
| RCA | 060, 202, 035, 077, 065, 042, 105, 149 |
| RadioShack | 037, 000 |
| Realistic | 104, 000, 037, 035, 066, 062, 047, 240, 104, 048, 046 |
| Richo | 034, 253 |
| Samsung | 240, 051, 053, 045 |
| Sansui | 041, 105, 082, 067, 008, 241 |
| Sanyo | 104, 046, 054, 066, 268, 240, 047 |
| Scott | 121, 184, 212, 210, 045 |
| Sears | 054, 066, 104, 047, 046, 037, 042, 057, 105 |
| Sharp | 048, 062 |
| Shintom | 072 |
| Sony | 034, 033, 032, 011, 253, 275 |
| STS | 042 |
| Sylvania | 035, 043, 000, 103, 081, 110 |
| Symphonic | 000 |
| Tatung | 041 |
| TEAC | 000, 041 |
| Technics | 035, 081, 110 |
| Teknika | 037, 035, 052, 000 |
| Toshiba | 043, 045, 210, 066, 057, 212 |
| Totevision | 240, 037 |
| Unitech | 240 |
| Vector Research | 040, 038 |
| Victor | 067, 008 |
| Video Concepts | 040, 061 |
| Videosonic | 240 |
| Wards | 240, 000, 035, 048, 072, 042, 062, 212, 149, 047 |
| Yamaha | 041, 038 |
| Zenith | 039, 033, 034, 032 |

U-Control Command Center Setup

The U-Control Command Center lets you remotely control lights and appliances from anywhere in your home. You can keep it near your home entertainment system or by your bed side. By using your U-Control II Remote Control or by manually pushing the buttons on the Command Center, you can turn off the TV or the lights around your home without getting out of your easy chair. You can turn off your child's radio, TV, or night light from your bedroom. If you hear a suspicious noise at night, you can turn on all lights connected to the U-Control II Lamp Modules and Wall Switch Modules with the push of a button on your Remote Control. You can even turn off everything in the system to save energy. Keep in mind that your U-Control Command Center always turns lamps and appliances on or off the instant you use your U-Control II Remote Control or you press the Command Center buttons. There can be some unexpected consequences if this feature is not used with care. For example, if you turn on an empty coffee pot remotely, it could be damaged from overheating. If an electric heater is turned on while clothing is draped over it, a fire could result. Do not use the system for the control of high-powered heating appliances, such as portable heaters.

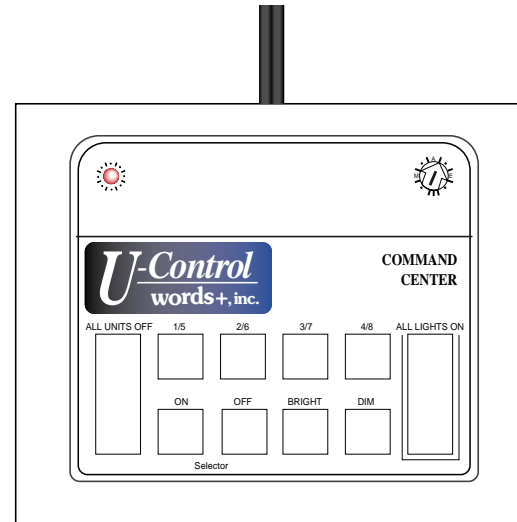

The U-Control Command Center activates lights and appliances throughout your home or apartment from any location. It receives signals from your U-Control II Remote Control or from the buttons you push on the Command Center's top panel and then transmits commands over existing house wiring to the modules. You plug lamps into Lamp Modules, plug appliances into Appliance Modules, and replace wall light switches with Wall Switch Modules. You then can control virtually every electrical operation in your home or apartment, including dimming and brightening lamps.

U-Control Command Center

- Lets you remotely control up to 16 U-Control II modules from anywhere in your home. Plug lamps and appliances into the modules, and replace wall switches with Wall Switch Modules to control important outside security lights.
- Receives commands from your U-Control II Remote Control.
- Sends signals to modules over your existing house or apartment wiring (no additional wiring is necessary).
- Dims and brightens lamps and lights.
- Turns off your child's radio, TV, or night light from your bedroom.
- Turns on all lights connected to the Lamp Modules and Wall Switch Modules with the touch of a button on your U-Control II Remote Control or on your Command Center.
- Turns off everything in the system with one button.

The Command Center receives signals from the buttons on its top panel or from your U-Control II Remote Control. Commands are sent over your existing house or apartment wiring to the module or modules of your choice. The modules respond to the commands. The Lamp Module turns on and off and dims and brightens any incandescent lamp (up to 300 watts). The Appliance Module turns on and off appliances, such as a window fan, a toaster, a coffee maker, or a manually controlled TV. It can also be used for a lamp, without the dimming feature. Your U-Control II Remote Control can control your TVs, VCRs, audio components, cable box and more! The Wall Switch Module turns on and off and dims and brightens any incandescent light (up to 500 watts) that is normally operated by a wall switch.

Commands are sent over existing wiring.

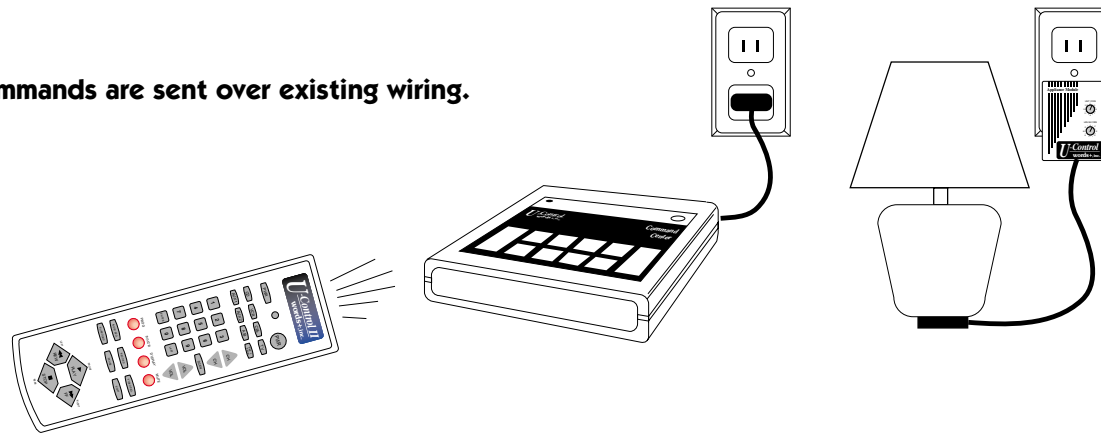

Installing Your Command Center

1. Plug the power cord into any functioning 120V outlet.
2. Using a small screwdriver, choose one of the 16 letters on the Command Center's HouseCode Dial.

Set the Command Center and all the modules you wish it to control on the same HouseCode letter. Having 16 choices for the HouseCode enables you to set up several independent systems in one home or apartment without interaction among them. Also, you can avoid interference with a neighbor's system by choosing a different HouseCode letter.

Installing and Setting Up the Modules

1. Install and set up all of your U-Control II modules by referring to the instructions included with them.
Be sure to turn off the power at the circuit breaker panel when installing Wall Switch Modules.
2. Set all of your modules to the same HouseCode that you set on the Command Center.
3. Set each module to a unit code between 1 and 16.

Installing the Command Center in Your Remote

The Remote Control needs to know that you are using the Command Center. To install, press these keys on your Remote Control:

- Press **PLUG 'N POWER**.
- Press and hold **SET UP** until the red indicator light blinks twice, then release it. Enter the three-digit code.

PLUG 'N POWER -SET UP-2-5-2.

The **PLUG 'N POWER** now controls your Command Center. You only need to do this once, not each time you use the Remote Control.

Turning On a Light or an Appliance.

You may turn on a light or an appliance by using your U-Control II Remote Control or by using the control panel on top of the Command Center. To use your Remote Control, aim it at the Command Center. Press the button marked **PLUG 'N POWER**, then press the unit code of the module you wish to control (1-9, 0=10, RECALL=11, ENTER=12, REWIND=13, PLAY=14, FAST FORWARD=15, STOP= 16). Press **CHANNEL UP** to turn it on. To use the Command Center's control panel, press and release the number key that corresponds to the unit code set on the module to be controlled, then press the **ON** key. The Selector Switch permits you to control modules with unit codes 1 through 4 or 5 through 8.

Turning Off a Light or an Appliance

As shown in the preceding section, you can turn off a light or an appliance by using either your U-Control II Remote Control or the control panel on top of the Command Center. To use your U-Control II Remote Control, aim it at the Command Center, press the **PLUG 'N POWER** button followed by the unit code of the module you wish to control (1-16, same as above), then press **CHANNEL DOWN**. To use the Command Center con-

trol panel, press and release the number key that corresponds to the unit code set on the module to be controlled, then press the **OFF** key. The Selector Switch determines which group of four unit codes is affected (1-4 or 5-8).

Dimming or Brightening Lights

Aim your U-Control II Remote Control at the Command Center and press **PLUG 'N POWER** followed by a unit code. Hold down **VOLUME UP** to brighten or **VOLUME DOWN** to dim, or press and release the number key on your Command Center's control panel for the Lamp Module or Wall Switch Module you wish to dim or brighten (you can't dim or brighten Appliance Modules). Then press the **BRIGHT** key to brighten the light or the **DIM** key to dim the light. Press the key until the desired brightness level is reached.

Intercom Systems

Intercom systems that send voice signals over existing electrical wiring may interfere with the operation of the Command Center when the intercom is in use. If the intercom system has its own separate wiring, it should not cause a problem.

Power Interruptions

When the power is restored after an outage, Lamp Modules and Wall Switch Modules will be off. Appliance Modules will stay as they were before the interruption.

Manual Control

Lights and appliances connected to plug-in modules are turned on with their own power switch. Simply turn the switch off and on once or twice. For lamps with three-way bulbs, you must rotate the power switch up to four times before the light comes on. The Wall Switch Module is turned on or off locally by using its push button. For example, the Power On-Off switch on the Wall Switch Module should be used to completely turn off the power before changing a light bulb.

Safety Precautions

Ratings for each of the modules are listed below. Do not exceed these ratings.

- Lamp Module - 300 watts max., incandescent only.
- Wall Switch Module - 500 watts max., 60 watts min., incandescent only. For safety, don't use with fluorescent, mercury, sodium, or low-voltage lights or with appliances, such as fans. It is designed for use with incandescent lights only. Don't use a Wall Switch Module to control a lamp or a fixture that already has a dimmer on it. Don't use a Wall Switch Module to control an outlet, unless you are sure no one will plug an appliance, such as a vacuum cleaner, into the outlet.
- Appliance Module - appliances rated 15 amp resistive, such as coffee pots and heaters; 1/3 H-P motor load; 400 watts for TV sets; and 500 watts for lamps (because of the "inrush current" from a cold lamp). Don't use for "instant-on" TVs, heavy-duty heating appliances, or anything that could be dangerous if it were turned on remotely and left unattended, such as an electric fan with poorly protected blades.

Turning All Lights On

To instantly turn on all lights connected to the Lamp Modules and the Wall Switch Modules (which are set to the same HouseCode as the Command Center), aim your U-Control II Remote Control at the Command Center and press **PLUG 'N POWER**, then the **POWER** button, or press the **ALL LIGHTS ON** key on the Command Center. This action does not affect Appliance Modules.

Turning All Lights and Appliances Off

Aim your U-Control II Remote Control at the Command Center and press **PLUG 'N POWER** followed by the **MUTE** button, or press the **ALL UNITS OFF** key to instantly turn off all modules (which are set to the same HouseCode as the Command Center), including appliance modules. To increase the convenience of using the U-Control II Remote Control with the Command Center, use a label from your Remote Control to record the unit codes and the lights and appliances they control. Attach it to the back of your U-Control II Remote Control.

Troubleshooting

If a particular module won't go on or off:

Make sure that you have power to the outlet controlling the module and that the switch on the light or appliance is on. Check that the unit code on the module is set to the correct number. Verify that the HouseCode on the module is the same as the code on the Command Center and that your U-Control II Remote Control is set to the correct device. Go to the "Determining the 3-Digit Code" section of the manual for assistance. If the problem persists, repeat the instructions outlined in the section entitled "Installing the Command Center in Your Remote." Try plugging the module and the Command Center into the same outlet. If the module doesn't work in any outlet, even with the module and Command Center in the same duplex receptacle (top and bottom), replace the module. If the module works in some outlets but not in others, contact 1-800-869-8521 for assistance.

If you can't control any module from the Command Center:

Verify that you have power to the outlet for the Command Center. Check to see if the HouseCode on the Command Center is set correctly. Try plugging the module and the Command Center into the same outlet. If none of the modules works in any outlet, even with the module and the Command Center in the same duplex receptacle (top and bottom), replace the Command Center. If the Command Center works in some outlets but not in others, call 1-800-869-8521 for assistance. Verify that your U-Control II Remote Control is set to the correct device by reviewing the instructions in the "Determining the 3-Digit Code" section of this manual. If your Remote Control is not set to the correct device, repeat the instructions for installing the Command Center on your Remote Control.

Please call Words+ at 1-800-869-8521 if you have any questions.

If you are unable to find a code to match your particular device, please call 1-800-950-7044 and have your model # 15-198 ready.

FCC Compliance Declaration of Conformity

| | |
|--------------------------------|---------------------------------------|
| Trade name: | AAC Accessories |
| Model number: | U-Control II |
| Compliance test report number: | A71125F1 |
| Compliance test report date: | November 25, 1997 |
| Responsible party (in U.S.A.): | Words+, Inc. |
| Address: | 1220 W. Avenue J, Lancaster, CA 93534 |
| Telephone: | 661-723-6523 |

This equipment has been tested and found to comply with the limits for a Class B digital device, pursuant to Part 15 of the FCC rules. These limits are designed to provide reasonable protection against harmful interference in a residential installation. This equipment generates, uses, and can radiate radio frequency energy and may cause harmful interference to radio communications if not installed and used in accordance with the instructions. There is no guarantee that interference will not occur in a particular installation.

If the unit does cause harmful interference to radio or television reception, please refer to your user's manual for instructions on correcting the problem.

I, the undersigned, hereby declare that the equipment specified above conforms to the above requirements.

Place: Los Angeles County

Signature: _____

Date: May 13, 1997

Full Name: Virginia E. Woltosz Position: Senior Vice President

Instruction to the User

This equipment has been tested and found to comply with the limits for a class B digital device, pursuant to part 15 of the FCC rules. These limits are designed to provide reasonable protection against harmful interference in a residential installation. This equipment generates, uses and can radiate radio frequency energy and may cause harmful interference to radio communications if not installed and used in accordance with the instructions. There is no guarantee that interference will not occur in a particular installation. If this equipment does cause harmful interference to radio or television reception, which can be determined by turning the equipment off and on, the user is encouraged to try to correct the interference by one or more of the following ways:

- Reorient or relocate the receiving antenna
- Increase the separation between the equipment and receiver
- Plug the equipment into an outlet on a different circuit from the one to which the receiver is connected
- Consult the dealer or an experienced radio/TV technician for help

In order to maintain compliance with FCC regulations, shielded cables must be used with this equipment. Operation with unapproved equipment or unshielded cables is likely to result in interference to radio and TV reception. The user is cautioned that changes and modifications made to the equipment without the approval of the manufacturer could void the user's authority to operate this equipment.